



The new RZM centric clamping vice from RÖHM is ideal for 5-axis processing centres.

Without any additional substructures or special jaws, the centric clamping unit holds the workpiece securely – with a minimum interference contour which is standard with 5-axis clamping.

**Technical features:**

- High position of the clamping jaws
- The spindle situated at the top, close to the jaws
- Long jaw guidings and compact design
- Outstanding guidance characteristics are based on a patent-protected jaw guidance system

**Customer advantages:**

- Very open design for optimised chip removal, so even in heavy machining operations it is easy to keep the vice clean
- Highly suitable for the use with SKB claw jaws. Unfinished parts and parts for processing with a strength up to max. 900N/mm<sup>2</sup> are securely clamped with a clamping depth of 2,5 mm.
- Flat jaws compatible to NC-Compact vice RKE

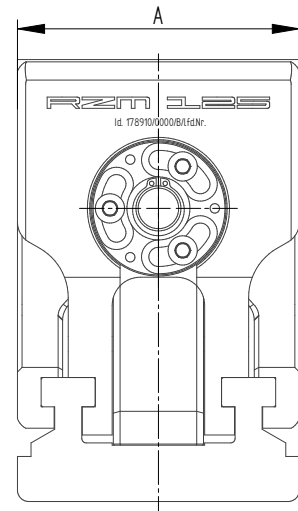
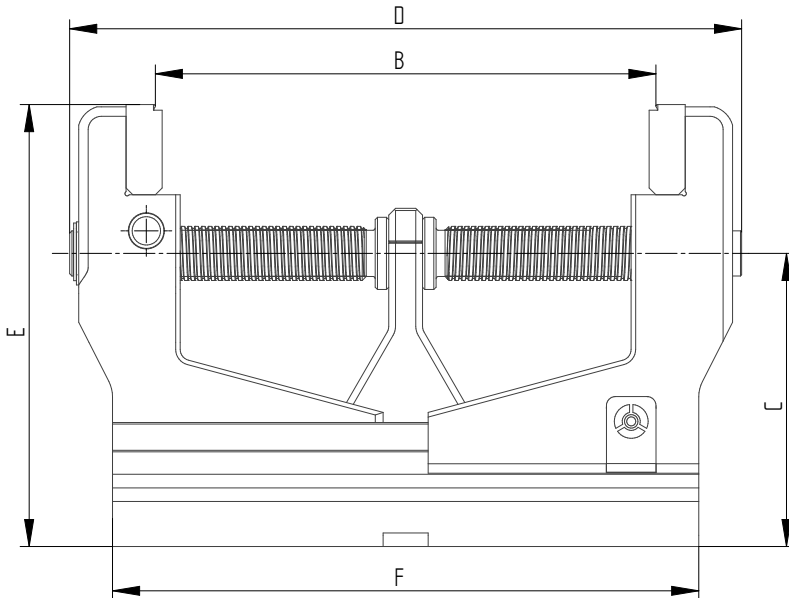

**Centric vice RZM**

Design	short design	long design
Item no.	178911	178910
Jaw width A	125	125
B min.	23	23
B max.	142	222
C	130	130
D	217	297
E	196	196
F	180	260
Clamping force kN	25	25
Weight aprox. kg	17,4	20,3
<b>Nettopris i DKK</b>	<del>14.965</del> <b>11.499,-</b>	<del>16.125</del> <b>11.999,-</b>

Alle priser i DKK ex. moms  
Der tages forbehold for trykfejl